

3-Wire Miniature 3-Leiter Miniatur

shielded
bündig
M5×0.5 | 1.5 mm



increased
erhöht

shielded
bündig
M5×0.5 | 1.5 mm



increased
erhöht

shielded
bündig
5 × 5 | 0.8 mm



standard

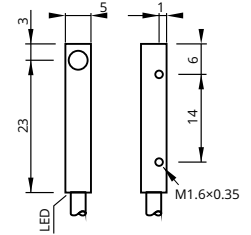
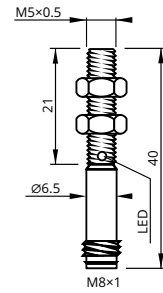
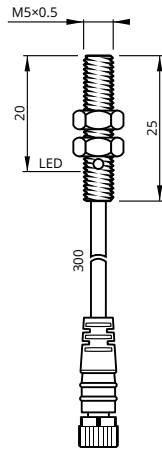

Sensing Distance	Schaltabstand	1.5 mm	1.5 mm	0.8 mm
Housing Size	Gehäusegröße	M5×0.5	M5×0.5	5 × 5
Operating Voltage	Betriebsspannung	10...30 V _{DC}	10...30 V _{DC}	10...30 V _{DC}
Reverse Polarity Protection	Verpolungsschutz	built-in integriert	built-in integriert	built-in integriert
Current Consumption	Stromverbrauch	<8 mA	<8 mA	<8 mA
Current Load Capability	Ausgangsbelaastbarkeit	200 mA	200 mA	200 mA
Short Circuit Protection	Kurzschlusschutz	built-in integriert	built-in integriert	built-in integriert
Voltage Drop	Spannungsabfall	<1.5 V @ 200 mA	<1.5 V @ 200 mA	<1.5 V @ 200 mA
Switching Frequency	Schaltfrequenz	2000 Hz	2000 Hz	2000 Hz
Correction Factor	Korrekturfaktor	Alu 0.45 · Brs 0.50 · VA 0.85	Alu 0.45 · Brs 0.50 · VA 0.85	Alu 0.45 · Brs 0.50 · VA 0.85
Repeatability	Wiederholgenauigkeit	<1% (S _n)	<1% (S _n)	<1% (S _n)
Hysteresis	Hysterese	3...15%	3...15%	3...15%
Operating Temperature	Betriebstemperatur	-25...+75 °C	-25...+75 °C	-25...+75 °C
Protection Class	Schutzklasse	IP67	IP67	IP67
Sensing Face	Sensorfläche	POM	POM	POM
Housing Material	Gehäusewerkstoff	SS303 Edelstahl	SS303 Edelstahl	brass Messing
Connection	Anschluss	PUR, 300 mm, M8	PUR, 300 mm, M8	PUR, ultra-flex
Switching Indicator	Schaltanzeige	built-in integriert	built-in integriert	built-in integriert
Article Code PNP, NO	—/—	INS5S1.5PO25-3U8	INS5S1.5PO40-M8	INS5S08PO26-A2P
Article Code PNP, NC	—/—	INS5S1.5PC25-3U8	INS5S1.5PC40-M8	INS5S08PC26-A2P
Article Code NPN, NO	—/—	INS5S1.5NO25-3U8	INS5S1.5NO40-M8	INS5S08NO26-A2P
Article Code NPN, NC	—/—	INS5S1.5NC25-3U8	INS5S1.5NC40-M8	INS5S08NC26-A2P

shielded
bündig
5 × 5 | 0.8 mm



standard

shielded
bündig
5 × 5 | 1.5 mm



increased
erhöht

shielded
bündig
5 × 5 | 1.5 mm



increased
erhöht

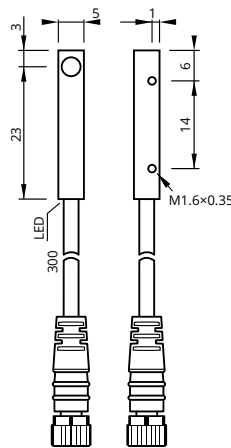
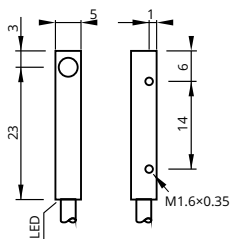
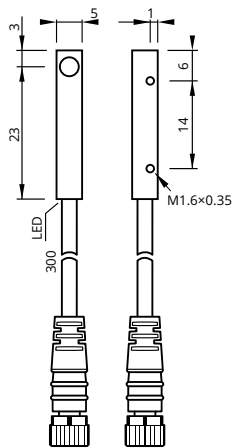

0.8 mm	1.5 mm	1.5 mm
5 × 5	5 × 5	5 × 5
10...30 V _{DC}	10...30 V _{DC}	10...30 V _{DC}
built-in integriert	built-in integriert	built-in integriert
<8 mA	<8 mA	<8 mA
200 mA	200 mA	200 mA
built-in integriert	built-in integriert	built-in integriert
<1.5 V @ 200 mA	<1.5 V @ 200 mA	<1.5 V @ 200 mA
2000 Hz	2000 Hz	2000 Hz
Alu 0.45 · Brs 0.50 · VA 0.85	Alu 0.45 · Brs 0.50 · VA 0.85	Alu 0.45 · Brs 0.50 · VA 0.85
<1% (S _n)	<1% (S _n)	<1% (S _n)
3...15%	3...15%	3...15%
-25...+75 °C	-25...+75 °C	-25...+75 °C
IP67	IP67	IP67
POM	POM	POM
brass Messing	brass Messing	brass Messing
PUR, 300 mm, M8	PUR, ultra-flex	PUR, 300 mm, M8
built-in integriert	built-in integriert	built-in integriert
INS55S08PO26-3U8	INS55S1.5PO26-A2P	INS55S1.5PO26-3U8
INS55S08PC26-3U8	INS55S1.5PC26-A2P	INS55S1.5PC26-3U8
INS55S08NO26-3U8	INS55S1.5NO26-A2P	INS55S1.5NO26-3U8
INS55S08NC26-3U8	INS55S1.5NC26-A2P	INS55S1.5NC26-3U8